

Material: Nickel-plated brass (tube inserts and ferrules brass with a bare metal surface)
 Pressure range: max. 60 bar
 Temperature: max. 150 °C

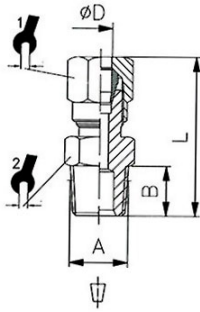

N 29

Male connectors, conical male thread acc. to ISO 7-1

| Type Nr. | Art Nr. | ØD mm | Thread A | B mm | L mm | SW1 mm | SW2 mm |
|----------|---------|-------|----------|------|------|--------|--------|
| N 21 | 111964 | 4 | R 1/8 | 8.0 | 27.0 | 10 | 10 |
| N 23 | 111965 | 6 | R 1/8 | 8.0 | 28.0 | 12 | 12 |
| N 24 | 111966 | 8 | R 1/8 | 8.0 | 29.5 | 14 | 12 |
| N 28 | 111967 | 6 | R 1/4 | 11.0 | 32.5 | 12 | 14 |
| N 29 | 111968 | 8 | R 1/4 | 11.0 | 33.0 | 14 | 14 |
| N 30 | 111969 | 10 | R 1/4 | 11.0 | 37.5 | 19 | 17 |
| N 34 | 111970 | 8 | R 3/8 | 11.5 | 33.0 | 14 | 17 |
| N 35 | 111971 | 10 | R 3/8 | 11.5 | 38.0 | 19 | 17 |
| N 36 | 111972 | 12 | R 3/8 | 11.5 | 39.0 | 22 | 19 |
| N 39 | 111973 | 10 | R 1/2 | 14.0 | 40.5 | 19 | 22 |
| N 40 | 111974 | 12 | R 1/2 | 14.0 | 41.0 | 22 | 22 |
| N 41 | 111975 | 15 | R 1/2 | 14.0 | 42.5 | 27 | 22 |
| N 42 | 111976 | 18 | R 1/2 | 14.0 | 43.0 | 32 | 26 |

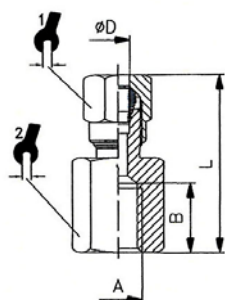

N 64

Pressure gauge fittings with female thread

| Type Nr. | Art Nr. | ØD mm | Thread A | B mm | L mm | SW1 mm | SW2 mm |
|----------|---------|-------|----------|------|------|--------|--------|
| N 60 | 111977 | 4 | G 1/8 | 8.0 | 24.5 | 10 | 14 |
| N 61 | 111978 | 6 | G 1/8 | 8.5 | 25.5 | 12 | 14 |
| N 62 | 111979 | 8 | G 1/8 | 8.0 | 26.5 | 14 | 14 |
| N 63 | 111980 | 6 | G 1/4 | 11.0 | 30.0 | 12 | 17 |
| N 64 | 111981 | 8 | G 1/4 | 11.0 | 31.0 | 14 | 17 |
| N 65 | 111982 | 10 | G 1/4 | 11.0 | 35.5 | 19 | 17 |
| N 66 | 111983 | 8 | G 3/8 | 11.5 | 31.0 | 14 | 20 |
| N 67 | 111984 | 10 | G 3/8 | 11.5 | 36.5 | 19 | 20 |
| N 68 | 111985 | 12 | G 3/8 | 11.5 | 36.0 | 22 | 20 |
| N 69 | 111986 | 12 | G 1/2 | 15.0 | 39.5 | 22 | 24 |
| N 70 | 111987 | 15 | G 1/2 | 15.0 | 40.0 | 27 | 24 |
| N 71 | 111988 | 18 | G 1/2 | 15.0 | 42.0 | 32 | 26 |

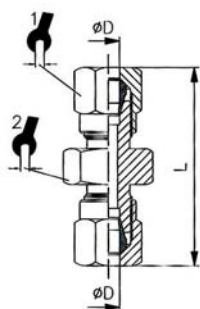

N 55

Unions, pipe connection on both sides

| Type Nr. | Art Nr. | ØD mm | L mm | SW1 mm | SW2 mm |
|----------|---------|-------|------|--------|--------|
| N 50 | 111989 | 4 | 34.0 | 10 | 10 |
| N 54 | 111990 | 6 | 35.0 | 12 | 12 |
| N 55 | 111991 | 8 | 38.5 | 14 | 14 |
| N 56 | 111992 | 10 | 47.5 | 19 | 17 |
| N 57 | 111993 | 12 | 48.0 | 22 | 19 |
| N 58 | 111994 | 15 | 50.0 | 27 | 24 |
| N 59 | 111995 | 18 | 56.0 | 32 | 26 |

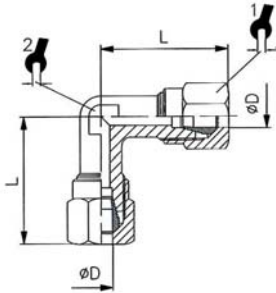

N 75

Union elbows, pipe connection on both sides

| Type Nr. | Art Nr. | ØD mm | L mm | SW1 mm | SW2 mm |
|----------|---------|-------|------|--------|--------|
| N 73 | 111996 | 4 | 21.0 | 10 | 9 |
| N 74 | 111997 | 6 | 23.0 | 12 | 9 |
| N 75 | 111998 | 8 | 24.0 | 14 | 11 |
| N 76 | 111999 | 10 | 32.0 | 19 | 13 |
| N 77 | 112000 | 12 | 34.5 | 22 | 15 |
| N 78 | 112001 | 15 | 38.0 | 27 | 17 |
| N 79 | 112002 | 18 | 44.0 | 32 | 22 |

Banjo elbows, parallel male thread with O-ring



N 84

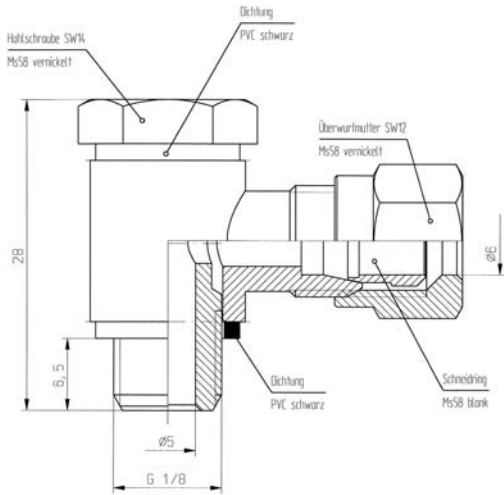

Type Nr. N 81
Art Nr. 112003

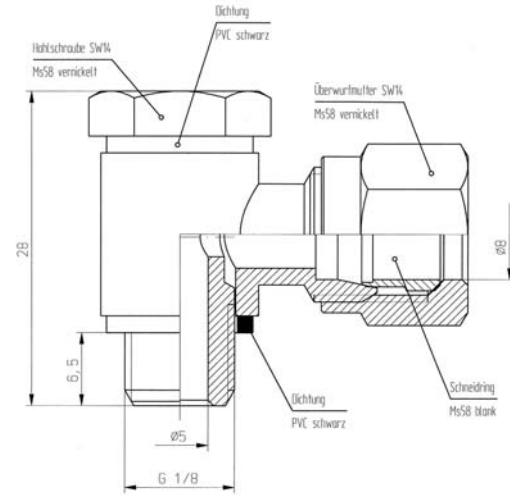

Type Nr. N 82
Art Nr. 112004

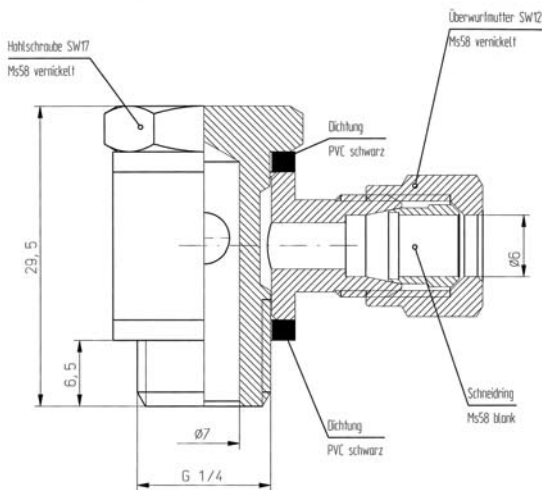

Type Nr. N 83
Art Nr. 112005

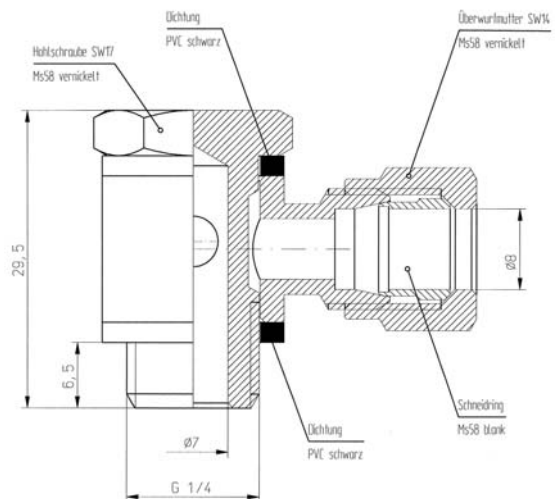

Type Nr. N 84
Art Nr. 112006

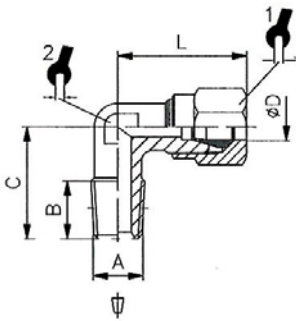

N 93

Male elbows, conical male thread acc. to ISO 7-1

| Type Nr. | Art Nr. | ØD mm | Thread A | B mm | C mm | L mm | SW1 mm | SW2 mm |
|----------|---------|-------|----------|------|------|------|--------|--------|
| N 89 | 112007 | 4 | R 1/8 | 8.0 | 16.0 | 21.0 | 10 | 9 |
| N 90 | 112008 | 6 | R 1/8 | 8.0 | 16.0 | 22.0 | 12 | 9 |
| N 91 | 112009 | 8 | R 1/8 | 8.0 | 17.0 | 24.0 | 14 | 11 |
| N 92 | 112010 | 6 | R 1/4 | 11.0 | 20.0 | 24.5 | 12 | 11 |
| N 93 | 112011 | 8 | R 1/4 | 11.0 | 20.0 | 24.0 | 14 | 11 |
| N 94 | 112012 | 10 | R 1/4 | 11.0 | 23.5 | 32.0 | 19 | 13 |
| N 97 | 112013 | 8 | R 3/8 | 11.5 | 24.0 | 27.0 | 14 | 13 |
| N 98 | 112014 | 10 | R 3/8 | 11.5 | 24.0 | 32.0 | 19 | 13 |
| N 99 | 112015 | 12 | R 3/8 | 11.5 | 25.5 | 34.5 | 22 | 15 |
| N 101 | 112016 | 10 | R 1/2 | 13.0 | 28.5 | 34.0 | 19 | 15 |
| N 102 | 112017 | 12 | R 1/2 | 13.0 | 28.5 | 34.5 | 22 | 15 |
| N 103 | 112018 | 15 | R 1/2 | 14.0 | 30.0 | 38.0 | 27 | 17 |
| N 104 | 112019 | 18 | R 1/2 | 14.0 | 34.0 | 44.0 | 32 | 22 |

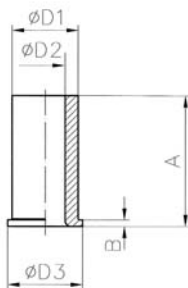

VH 8

Tube inserts (brass with a bare metal surface)

| Type Nr. | Art Nr. | Tube O.D. mm | D1 mm | D2 mm | D3 mm | A mm | B mm |
|----------|---------|--------------|-------|-------|-------|------|------|
| VH 2 | 112020 | 4x2 | 2.0 | 1.3 | 3.5 | 8.0 | 0.3 |
| VH 4 | 112021 | 6x4 | 4.0 | 3.5 | 5.0 | 10.0 | 0.4 |
| VH 6 | 112022 | 8x6 | 6.0 | 5.5 | 8.0 | 15.0 | 0.5 |
| VH 8 | 112023 | 10x8 | 8.0 | 7.0 | 10.0 | 15.0 | 0.5 |
| VH 9 | 112024 | 12x9 | 9.0 | 8.0 | 12.0 | 15.0 | 0.5 |
| VH 10 | 112025 | 12x10 | 10.0 | 9.0 | 12.0 | 15.0 | 0.5 |
| VH 12 | 112026 | 15x12 | 12.0 | 11.0 | 15.0 | 15.0 | 0.5 |
| VH 14 | 112027 | 18x14 | 14.0 | 13.0 | 17.0 | 18.0 | 0.6 |

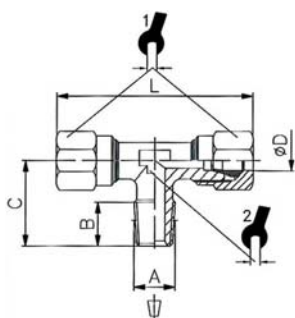

N 117

Male branch tees, conical male thread acc. to ISO 7-1

| Type Nr. | Art Nr. | ØD mm | Thread A | B mm | C mm | L mm | SW1 mm | SW2 mm |
|----------|---------|-------|----------|------|------|------|--------|--------|
| N 110 | 112028 | 4 | R 1/8 | 8.0 | 16.0 | 44.0 | 10 | 9 |
| N 112 | 112029 | 6 | R 1/8 | 8.0 | 16.0 | 46.0 | 12 | 9 |
| N 115 | 112030 | 8 | R 1/8 | 8.0 | 17.0 | 48.0 | 14 | 11 |
| N 116 | 112031 | 6 | R 1/4 | 11.0 | 20.0 | 46.0 | 12 | 11 |
| N 117 | 112032 | 8 | R 1/4 | 11.0 | 20.0 | 48.0 | 14 | 11 |
| N 118 | 112033 | 10 | R 1/4 | 11.0 | 23.5 | 64.0 | 19 | 13 |
| N 119 | 112034 | 8 | R 3/8 | 11.5 | 24.0 | 54.0 | 14 | 13 |
| N 120 | 112035 | 10 | R 3/8 | 11.5 | 24.0 | 64.0 | 19 | 13 |
| N 121 | 112036 | 12 | R 3/8 | 11.5 | 25.5 | 69.0 | 22 | 15 |
| N 124 | 112037 | 12 | R 1/2 | 14.0 | 28.5 | 69.0 | 22 | 14 |
| N 125 | 112038 | 15 | R 1/2 | 14.0 | 30.0 | 76.0 | 27 | 17 |
| N 126 | 112039 | 18 | R 1/2 | 14.0 | 34.0 | 88.0 | 32 | 22 |

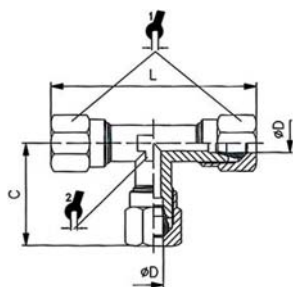

N 136

Branch tees, pipe connection on all sides

| Type Nr. | Art Nr. | ØD mm | C mm | L mm | SW1 mm | SW2 mm |
|----------|---------|-------|------|------|--------|--------|
| N 130 | 112040 | 4 | 21.0 | 44.0 | 10 | 9 |
| N 135 | 112041 | 6 | 23.0 | 46.0 | 12 | 9 |
| N 136 | 112042 | 8 | 24.0 | 48.0 | 14 | 11 |
| N 137 | 112043 | 10 | 32.0 | 64.0 | 19 | 13 |
| N 138 | 112044 | 12 | 34.5 | 69.0 | 22 | 15 |
| N 139 | 112045 | 15 | 38.0 | 76.0 | 27 | 17 |
| N 140 | 112046 | 18 | 44.0 | 88.0 | 32 | 22 |

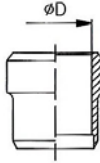

N 353

Ferrules (brass with a bare metal surface)

| Type Nr. | Art Nr. | ØD mm |
|----------|---------|-------|
| N 350 | 112047 | 4 |
| N 352 | 112048 | 6 |
| N 353 | 112049 | 8 |
| N 362 | 112050 | 10 |
| N 363 | 112051 | 12 |
| N 364 | 112052 | 15 |
| N 365 | 112053 | 18 |

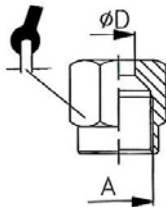

N 403

Swivel nuts

| Type Nr. | Art Nr. | ØD mm | A mm | SW mm |
|----------|---------|-------|---------|-------|
| N 400 | 112054 | 4 | M8x1,0 | 10 |
| N 402 | 112055 | 6 | M10x1,0 | 12 |
| N 403 | 112056 | 8 | M12x1,0 | 14 |
| N 407 | 112057 | 10 | M16x1,5 | 19 |
| N 408 | 112058 | 12 | M18x1,5 | 22 |
| N 409 | 112059 | 15 | M22x1,5 | 27 |
| N 410 | 112060 | 18 | M26x1,5 | 32 |